

2020



Arena – Phase 3

Site Specific Safety Plan

Nelson Civic Center Arena

Updated: September 28, 2020



R.D.C.K. – Nelson Civic Center COVID 19 ARENA Site Safety Plan

Updated: September 28, 2020

Introduction

The following protocols are in place based on direction from the Ministry of Health, Provincial sport organization and BC Work Safe guidelines.

Masks must be worn in all areas of the Community Complex except field of play.

Facility Protocols for Phase 3

Occupancy Limits

1. See attached **Traffic Flow & Occupancy Map** for occupancy limits within each space in the arena.
2. The occupancy limit for events in arenas has been determined by the British Columbia Recreation and Parks Association and the BC Public Health Officer's order on August 7th, 2020.
 - a. The occupancy limit for the ice in Phase 3 is 50 people but if there are instances where groups are choosing to follow Phase 2 protocols to remain physically distant, the ice maximum is 25 and 5 each for the players' benches.
3. Combined arena attendance must not exceed 50 people within the facility. Recreation staff will not be included in this total.
4. One parent or guardian per athlete (no siblings or other children) is permitted to enter the arena. If the parent or guardian needs to stay, a designated space in the bleachers will be available to watch. Two metre physical distancing is required.

Upon Arrival

1. Access to the facility will be permitted a maximum of 15 minutes prior to the scheduled use.
2. All ice users should be prepared to come dressed in as much equipment as possible.
3. Dressing rooms are for limited usage.
4. All ice users will use the Right- Hand Civic Center Double doors to enter the arena. Users will use the designated physical distancing line for Arena activities prior to doors opening.
5. Non-medical masks will be required upon entry to the facility in all common public areas including, dressing rooms and hallways.
6. **Designated Arena Attendant:** Each user group is required to provide an attendant to let their group into the facility and monitor their group ensuring all required Public Health Orders and Site Safety plan Guidelines are adhered to. Attendants must be identifiable.
 - Attendant is to arrive 30 minutes prior to ice session to ensure facility staff can let them in the building.



- Attendant must not access any other areas of the facility during this time (must remain at the doors).
 - Attendant will monitor the door and only allow facility access to their group 15 minutes prior to the start of their ice time (no exceptions).
 - Arena Attendant will also facilitate the user exiting the building within 15 minutes after ice time ends, so that the next group is able to enter the Arena on time.
 - Attendant will create and keep an attendance list for all participants (with first and last names, phone numbers, and/or email addresses) of the event, including parents, spectators, and anyone associated with the user group (Provincial Health Officer Order dated August 7, 2020).
 - The attendance list must be emailed to the Nelson & District Community Complex within 24 hours after the booking to NelCovidList@rdck.bc.ca.
7. Late arrivals and re-entry will be permitted if the attendant is available at the door to check-in the individuals.
 8. Upon entering the arena, participants will use Hand hygiene, i.e. hand sanitizer.
 9. All Participants entering the Facility will be aware of and maintain physical distancing at all times.
 10. Patrons will follow the directional arrows to designated spaces for putting on skates and additional equipment and wait until their ice time begins.
 11. All belongings must be left at your designated space during your ice session.
 12. Water bottles can be filled in dressing rooms.
 - Please bring a filled water bottle.
 - Drinking fountains will be closed

Dressing Rooms / Washrooms

1. Minimal changing will be permitted in dressing rooms. Skaters are expected to arrive and leave dressed in as much equipment as possible. Goal tenders may bring in and put on pads.
2. See attached **Traffic Flow & Occupancy Map** for occupancy limits in the dressing rooms.
3. Use of showers is prohibited.
4. Public Bathrooms will be available on concourse level.
5. Users must wear masks in the dressing rooms and hallways where participants are getting ready. Masks are worn up to the time participants proceed to the ice session and as soon as returning from the ice session.

Ice Usage

1. Please refrain from spitting anywhere in the facility or on the ice.
2. Users will remain seated in the seating area until their ice time begins. Users will ensure physical distancing while entering ice surface.
3. Non-medical masks can be removed upon entering the Field of Play, which includes players' benches.
4. For cohort play, player benches are considered part of the field of play and there is no bench maximum
 - a. Phase 2-style play will only allow for a maximum of 5 people, physically distanced, per bench as marked (coaches and skaters only permitted on benches).
5. Setup and takedown of all related equipment must be done during the allotted ice booking.



6. User groups will complete a Sport specific safety plan outlining Arena activity usage for all areas while in the Arena.
7. Cohorts will follow their provincial sport organization’s sport-specific guidelines for rules of play and contact on the field of play.

** In case of emergency, exit the ice surface in the same manner as entering. Wait on your designated seats (staging area) for further instruction.

Exiting Procedure

1. Users will be designated 15 minutes after the booked ice time to take off skates, equipment and exit the building.
 - Patrons will be directed to exit the arena using the staircase Opposite the entrance, which will be marked “EXIT”.

Storage

1. When applicable, storage may be provided at the discretion of the RDCK.
2. User groups that currently have storage will need to submit storage access as part of their COVID19 Safety Plan.

Additional Safety Protocols

1. Staff will reduce interactions with users as much as possible and physically distance at all times.
2. Updated COVID Safety Guidelines provided by BC Work Safe are currently in place. RDCK staff will use all required PPE to respond or participate in response to first aid incidents within the facility.
3. User groups are required to designate a First Aid Attendant and have first aid supplies available, including required PPE. User groups shall notify NDCC staff of all major first aid incidents that require 911 assistance.
4. A scaled approach, based on frequency of touch points, will be used to plan cleaning schedules (see table below):

Frequency of Touch Points	Examples	Recommended cleaning and disinfecting frequency
High	- Participant staging area (seats used for lacing skates and putting on equipment) - Arena door handles	Minimum, 4 times per day
Moderate	- Player benches	Minimum 2 times per day
Low	- Seating areas (stands) - Concourse floor - Public Washrooms	Minimum 1 time per day

Attachments:

1. Site Specific Traffic Flow & Occupancy Map

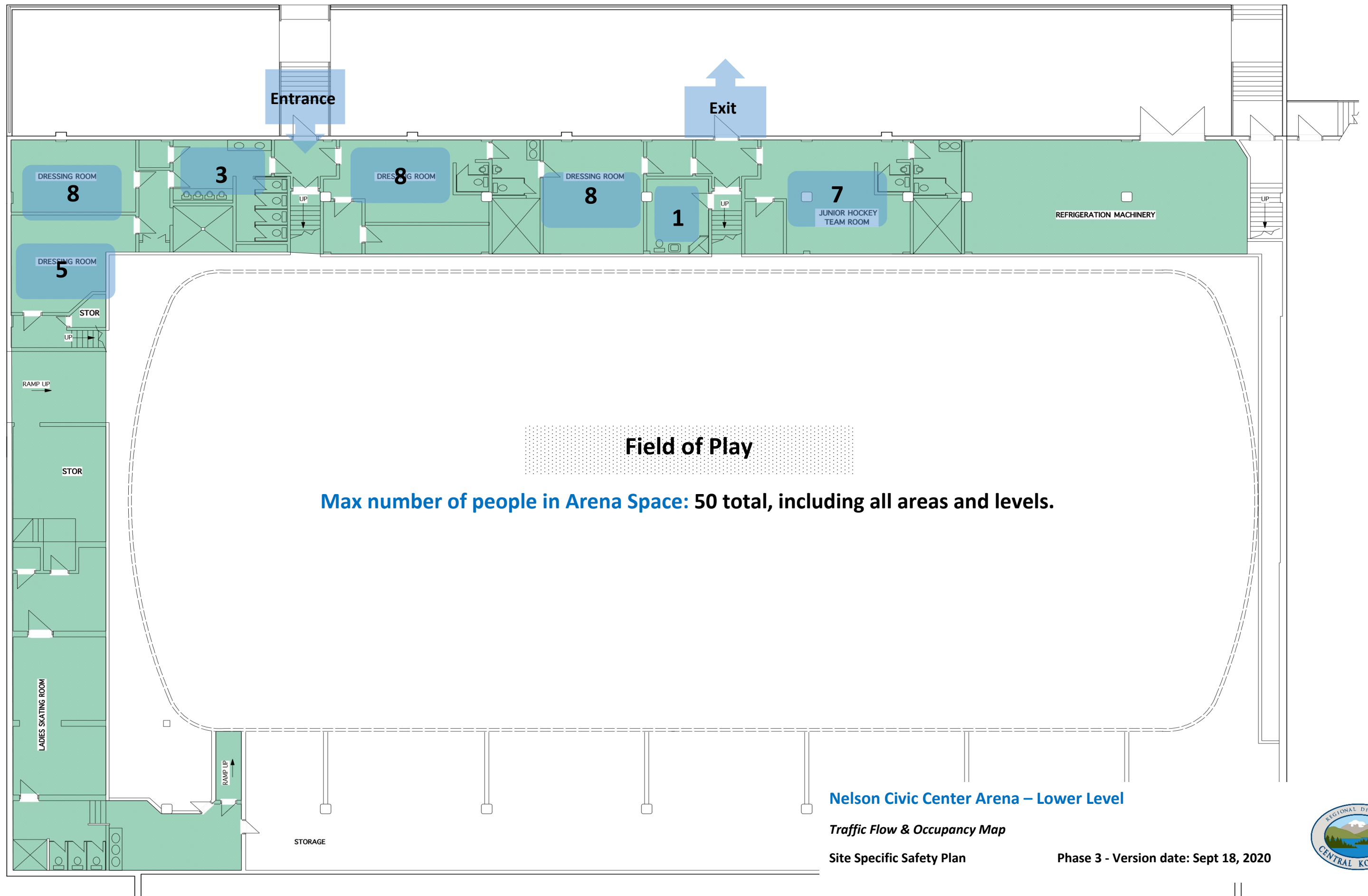

Max number of people in Arena Space: 50 total, including all areas and levels.

Nelson Civic Center Arena – Lower Level

Traffic Flow & Occupancy Map

Site Specific Safety Plan

Phase 3 - Version date: Sept 18, 2020



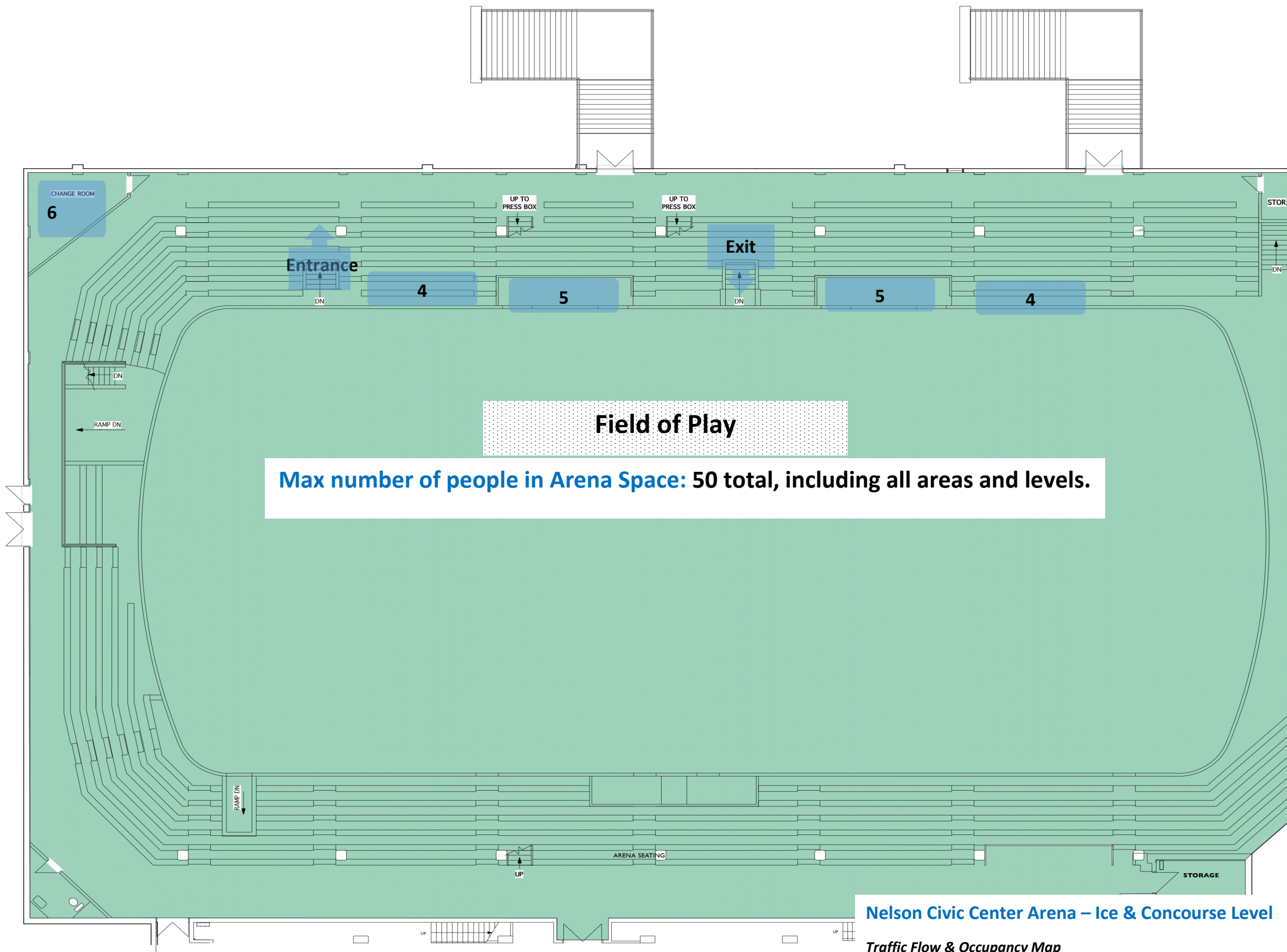

Nelson Civic Center Arena – Ice & Concourse Level

Traffic Flow & Occupancy Map

Site Specific Safety Plan

Phase 3 - Version date: Sept 18, 2020

25258 Square Feet (Interior Net Area)

